

Mapped for Swamp 23  
 T V IR XX III S & E

Land District East  
 Territory of Florida

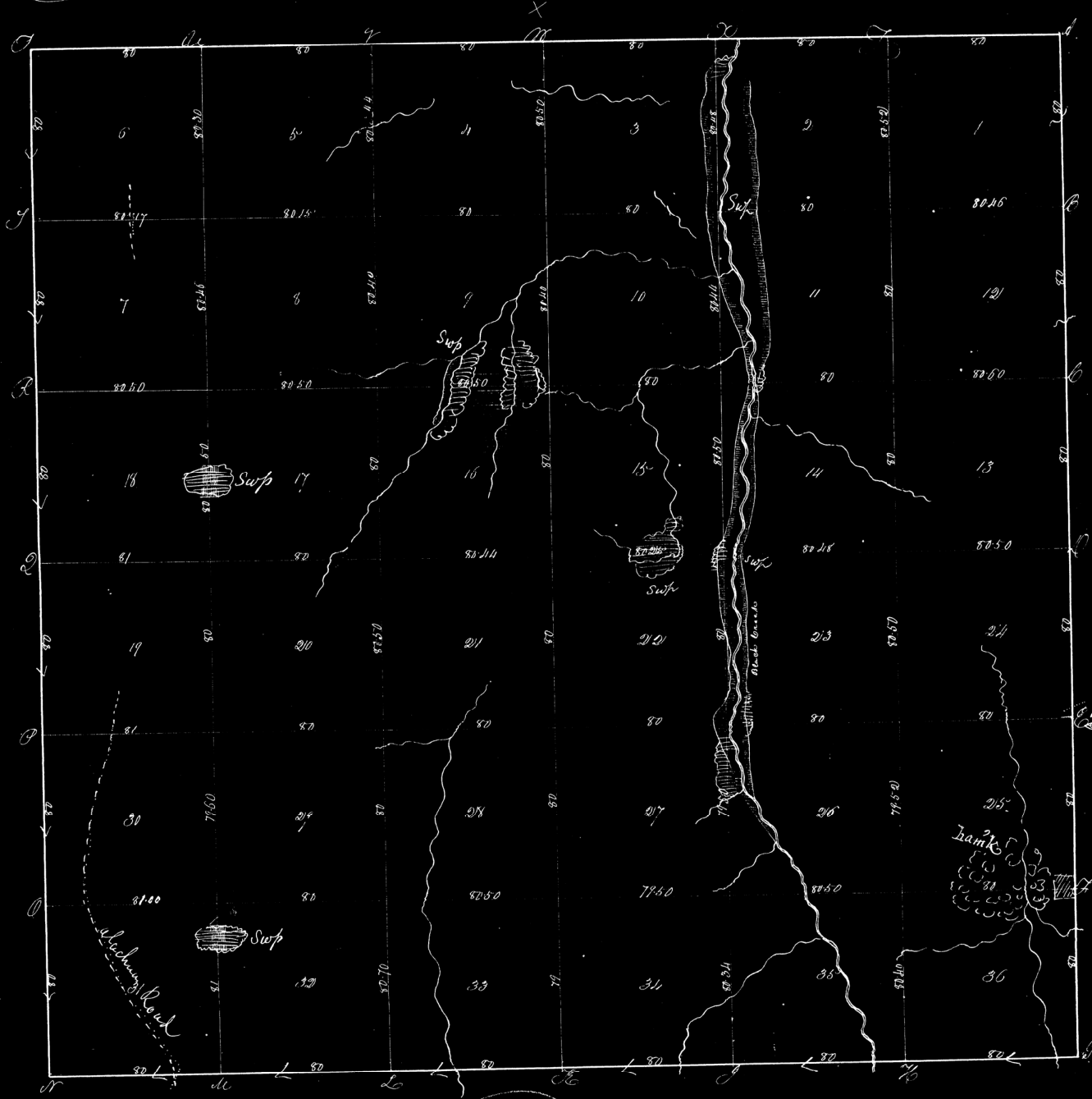

Table of Contents

No	Acres	No	Acres	No	Acres
1	643.92	13	624.10	25	635.35
2	624.00	14	643.92	26	635.35
3	643.92	15	623.60	27	636.20
4	643.76	16	643.76	28	642.42
5	643.56	17	644.00	29	635.40
6	641.80	18	648.01	30	646.33
7	644.52	19	648.00	31	648.09
8	646.25	20	642.00	32	646.80
9	643.21	21	643.76	33	640.70
10	643.36	22	641.00	34	635.30
11	641.76	23	643.92	35	644.90
12	644.24	24	642.00	36	641.63
7726.10		7729.77		7676.39	
Total in Township				23152.26	

David Thomas Deputy Surveyor  
 Surveyed in the 4th of 1830 & 1st of 1831  
 John A. Little  
 Henry Singletary & James Chainman  
 Variations 6° 10' East  
 Scale 40 chains to an inch

Examined & compared with field notes  
 Approved January 1834.

James Little  
 Civil Engineer  
 of Fla.

Manerke