

Reduced  
 Township VIII Range XXV South and East  
 Mapped

Land District East  
 Territory of Florida

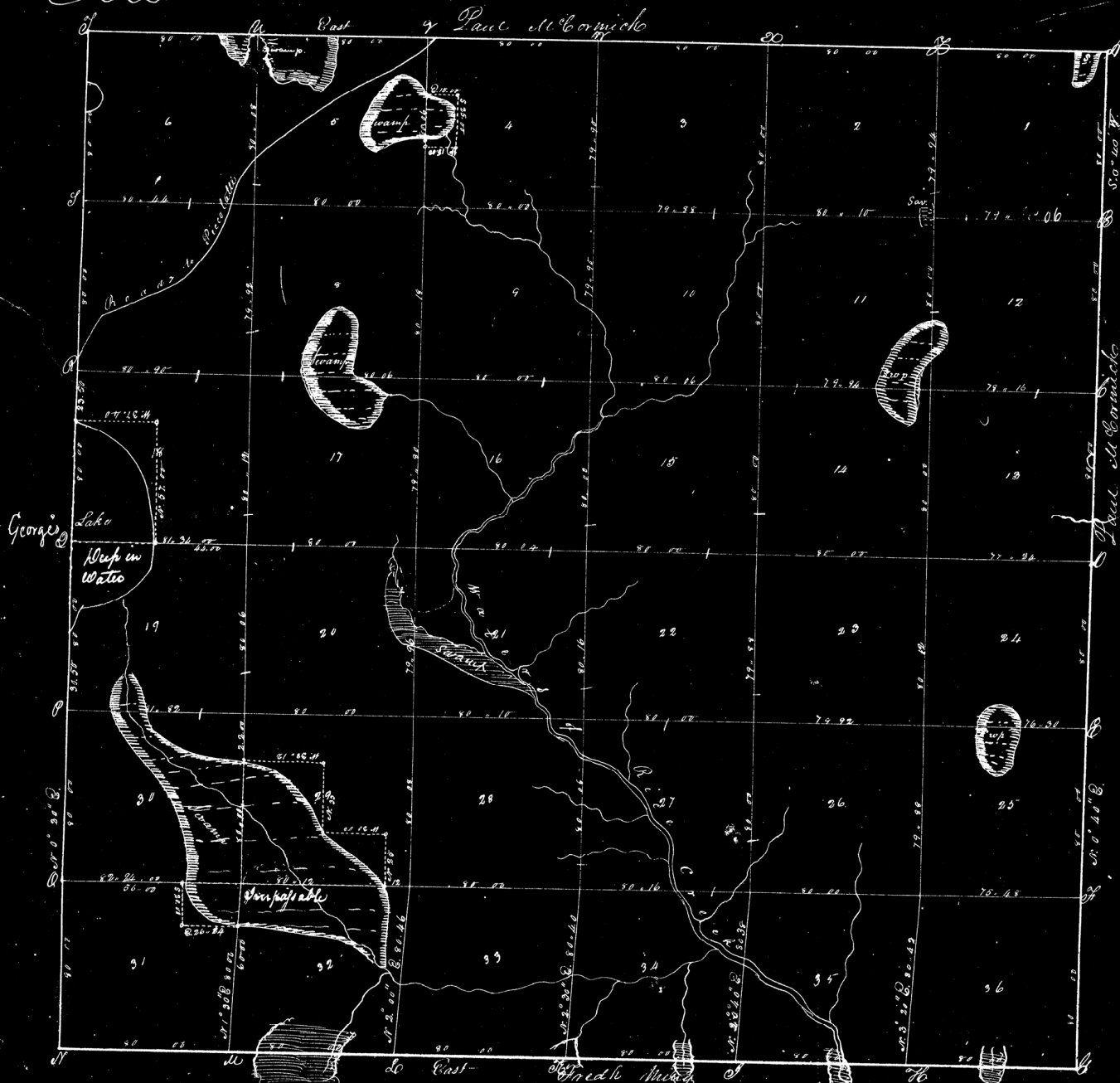

Table of Contents

no	Area	no	Area	no	Area
1	636. 00	13	621. 60	25	606. 64
2	640. 16	14	639. 76	26	639. 30
3	639. 12	15	640. 24	27	621. 88
4	639. 84	16	638. 72	28	640. 96
5	640. 56	17	639. 92	29	640. 32
6	642. 08	18	642. 44	30	656. 24
7	645. 12	19	653. 88	31	648. 64
8	640. 64	20	640. 08	32	642. 16
9	640. 88	21	641. 84	33	643. 84
10	639. 06	22	640. 16	34	643. 26
11	640. 16	23	639. 68	35	642. 56
12	639. 84	24	614. 16	36	623. 26
7673. 48		7657. 68		7667. 84	
				7659. 68	
				7672. 40	
Total in Township				32797. 92	

Paul McCormick Deputy Surveyor  
 Surveyed in the 3rd. quarter of the year 1833  
 Michael Higgins & James Warris were  
 chain men, John G. Blitch, Seaborn J.  
 Stringer and James N. Lee were marking  
 & flag bearers  
 Variation 5° 10' East  
 Scale of 40 chains to an inch

Examined compared with field notes  
 Approved. April 1834.

James Dutton  
 Com. Gen. & Co.

Exc Thompson

Transcribed